

Surface Mount - Installation Instruction

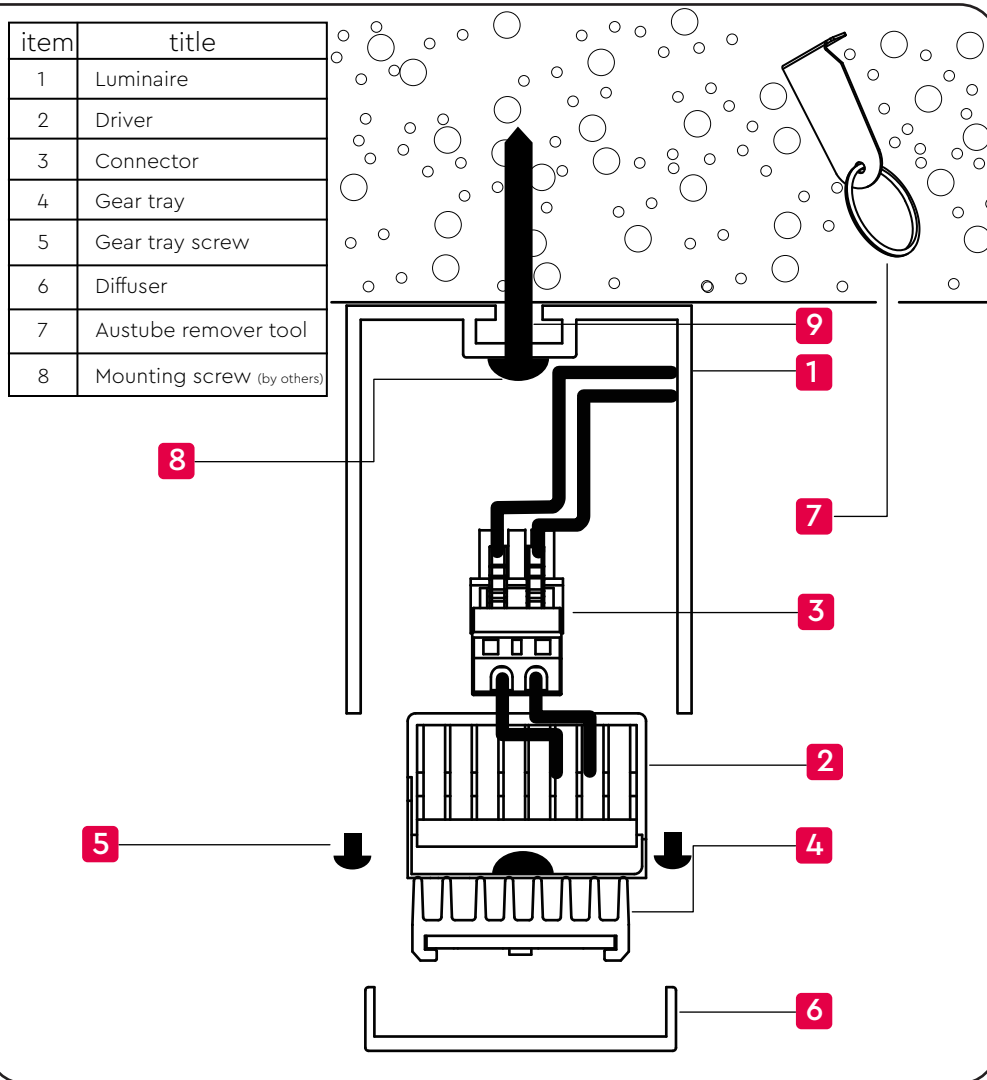

Important note: Install/service by licensed/authorised installer only.

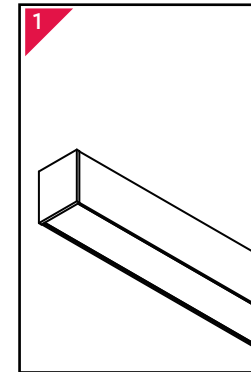

1
Ensure unit is safe and secured before proceeding

Note: Make sure power is disconnected

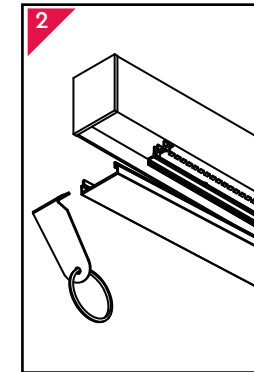

2
Use Austube remover tool to remove diffuser

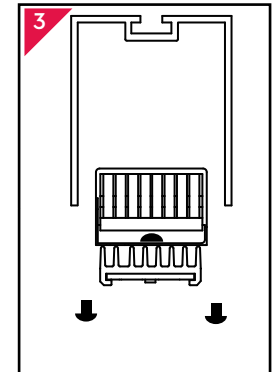

3
Carefully unscrew and remove gear tray

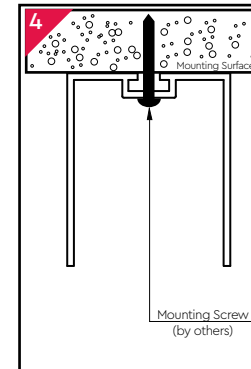

4
Drill & secure mounting screw to the surface through the luminaire as shown

Note: Refer to layout plan for mounting location

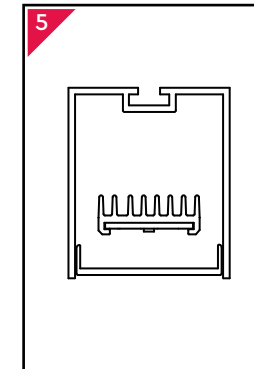

5
Retrace steps 3 & 2
Make sure all cables are cleared from pinching and gear tray is screwed back in

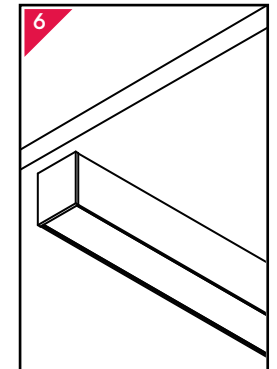

6
Make sure system is reconnected and secure to complete